

3. High Voltage DC Pulse Capacitors : STHVP-AN series

Applications :

- High Voltage and High Current application
- Can be used for repetition frequency 1Hz to 50Hz
- High Voltage Switch Absorption
- Filter applications
- Pulse Discharge Circuit and Vibration
- Can be used in High-End Medical equipments
- Can be used in the Semiconductor Industry
- Can be used in large electromechanical equipment protection facilities

Features :

- Polypropylene film dielectric
- Low inductance
- Excellent Frequency Response
- RMS Current Rating
- High peak Pulse Current Ratings (dv/dt)
- Higher Temperature range
- DC Blocking / Ultra-Low Leakage version on request

When compare with traditional Paper Dielectric, Oil Impregnated and Metal Enclosure Capacitor :

- Plastic enclosure : safer when compare with oil impregnated capacitor.
- Dry construction : Epoxy Resin end seal and doesn't have impregnant leakage problem
- Plastic enclosure and Epoxy Resin are flame retardant UL94-V0 grade
- higher Insulation Resistance and Insulation Voltage

Electrical Characteristics :

Rated Voltage : 15kVdc – 30kVdc / 3,500Vac – 5,000Vac

Capacitance range : 0.1uF – 0.5uF with **Tolerance** : +/-10% at 23C

Rated Temperature : +70C / +85C

Insulation Resistance :250Vdc +23C >= 50,000Mohm

Testing Voltage Terminal to Terminal : $V_{peak} : 1.4 \times \text{rated Vdc}$ 10 seconds at 23C
 $V_{ac} : 1.4 \times \text{rated Vac}$ 10 seconds at 23C

Accelerated Life : 1.25 x Vdc or Vac at rated Temperature for 2,000 hours

Maximum Ripple Current : up to 40A

Peak discharge current - I peak : up to 4,000A

Temperature range : -25C to +70C / -25C to +85C (depends on capacitor raw materials)

Ultra-Low Leakage version is available on request

Our capacitors can be customized according to the customer's requirement

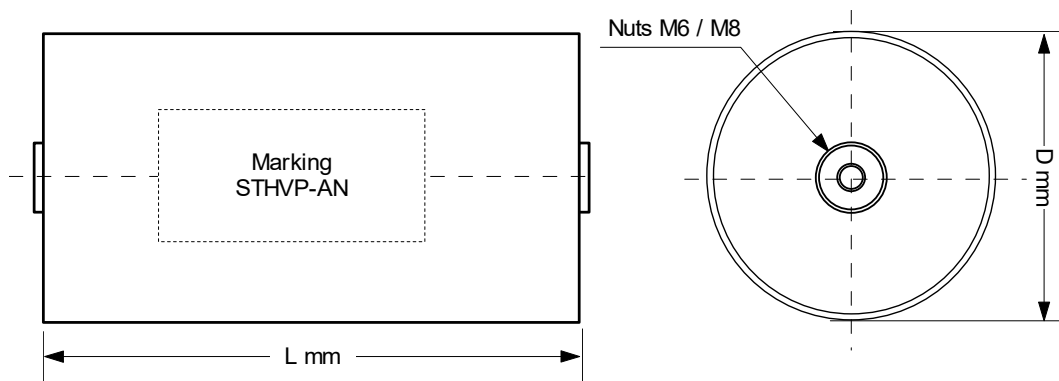

Specifications and Size :
STHVP-AN : 15kVdc / 3500Vac

P/N :	Cn uF	Diameter D mm	Length L mm	dv/dt v/us	Peak Current I _{p-p} A	ESL nH	ESR (mohm) 100KHz	Max. Irms 70C	Max. Irms 85C
STHVP-AN154K15kD	0.15	65	240	6271	941	50	7.5	15	12
STHVP-AN224K15kD	0.22	90	240	6271	1380	50	7	18	15
STHVP-AN254K15kD	0.25	90	240	6271	1568	50	6.6	18	15
STHVP-AN274K15kD	0.27	90	240	6271	1693	50	6.2	25	20
STHVP-AN334K15kD	0.33	90	240	6271	2069	50	5.8	30	25
STHVP-AN504K15kD	0.5	90	295	6271	3136	60	5.5	40	30

STHVP-AN : 20kVdc / 4000Vac

P/N :	Cn uF	Diameter D mm	Length L mm	dv/dt v/us	Peak Current I _{p-p} A	ESL nH	ESR (mohm) 100KHz	Max. Irms 70C	Max. Irms 85C
STHVP-AN154K20kD	0.15	65	295	6968	1045	60	10	17	13
STHVP-AN224K20kD	0.22	90	295	6968	1533	60	9.5	20	15
STHVP-AN254K20kD	0.25	90	295	6968	1742	60	8.7	25	20
STHVP-AN334K20kD	0.33	90	295	6968	2299	60	8	30	25
STHVP-AN504K20kD	0.5	90	295	6968	3484	60	7.5	40	35

STHVP-AN : 25kVdc / 4500Vac

P/N :	Cn uF	Diameter D mm	Length L mm	dv/dt v/us	Peak Current I _{p-p} A	ESL nH	ESR (mohm) 100KHz	Max. Irms 70C	Max. Irms 85C
STHVP-AN104K25kD	0.1	65	295	8710	871	70	12	12	10
STHVP-AN124K25kD	0.12	65	295	8710	1045	70	11	15	12
STHVP-AN154K25kD	0.15	65	295	8710	1307	70	10	18	15
STHVP-AN224K25kD	0.22	90	295	8710	1916	70	9.5	20	17
STHVP-AN254K25kD	0.25	90	295	8710	2178	70	8.5	25	20
STHVP-AN274K25kD	0.27	90	295	8710	2352	70	8.0	25	20

STHVP-AN : 30kVdc / 5000Vac

P/N :	Cn uF	Diameter D mm	Length L mm	dv/dt v/us	Peak Current I _{p-p} A	ESL nH	ESR (mohm) 100KHz	Max. Irms 70C	Max. Irms 85C
STHVP-AN104K30kD	0.1	65	295	10452	1045	70	12	12	10
STHVP-AN124K30kD	0.12	65	295	10452	1254	70	11	15	12
STHVP-AN154K30kD	0.15	65	295	10452	1568	70	10	18	15
STHVP-AN224K30kD	0.22	90	295	10452	2299	70	9.5	20	17
STHVP-AN254K30kD	0.25	90	295	10452	2613	70	8.5	25	20
STHVP-AN274K30kD	0.27	90	295	10452	2822	70	8.0	25	20

For any Capacitance, Voltage, dv/dt and Peak Pulse Discharge Current not listed, please contact us for a suggestion.