

**5. High Voltage Filter Capacitors :  
STHVF-AN : with screw nut at both ends**

**Applications :**

- High Voltage By-pass DC/AC Filtering, Transient and Harmonic Damping
- Coupling and Decoupling
- Filter applications
- Voltage Multiplier
- Induction heating
- X-Ray power supplies
- High Power lines
- Semiconductor industry
- Surge protection
- High current, high pulse discharge circuit
- Large electromechanical equipment
- Highly absorbent and protective



**Features :**

- Polypropylene film dielectric
- Low inductance
- Excellent Frequency Response
- RMS Current Rating
- High peak Pulse Current Ratings (dv/dt)
- Higher Temperature range
- DC Blocking / Ultra-Low Leakage version on request

**When compare with traditional Paper Dielectric, Oil Impregnated and Metal Enclosure Capacitor :**

- Plastic enclosure : safer when compare with oil impregnated capacitor.
- Dry construction : Epoxy Resin end seal and doesn't have impregnant leakage problem
- Plastic enclosure and Epoxy Resin are flame retardant UL94-V0 grade
- higher Insulation Resistance and Insulation Voltage

**Electrical Characteristics : STHVF series**

**Rated Voltage :** 6,300Vdc – 25KVdc / 2,100Vac – 4,500Vac

**Capacitance range :** 0.12uF – 1.5uF with **Tolerance :** +/-10% +/-5% at 23C

**Rated Temperature :** +70C / +85C

**Insulation Resistance :** 250Vdc +23C >= 50,000Mohm

**Testing Voltage** Terminal to Terminal : Vdc : 1.4 x rated Vdc 10 seconds at 23C  
Vac : 1.4 x rated Vac 10 seconds at 23C

**Accelerated Life :** 1.25 x Vdc or Vac at rated Temperature for 2,000 hours

**Maximum Ripple Current :** up to 50A

**Peak discharge current - I peak :** up to 3,000A

**Temperature range :** +70C / +85C ( depends on capacitor raw materials )

Ultra-Low Leakage version is available on request

Our capacitors can be customized according to the customer's requirement

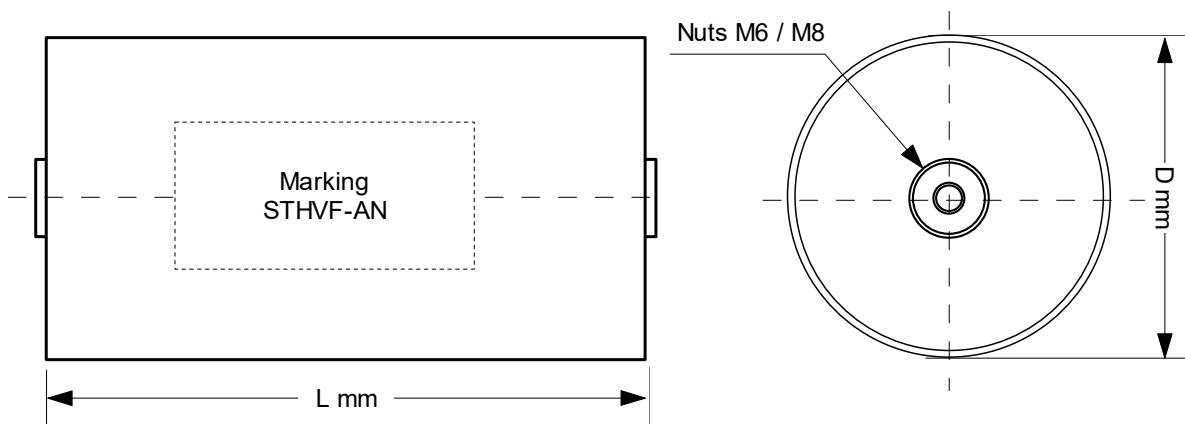

**Specifications and Size :**  
**STHVF-AN : 6300Vdc / 2100Vac**

P/N :	Cn uF	Diameter D mm	Length L mm	dv/dt v/us	Peak Current I <sub>p-p</sub> A	ESL nH	ESR (mohm) 100KHz	Max. I <sub>rms</sub> 70C
STHVF-AN334K6300D	0.33	65	140	1921	634	30	6	15
STHVF-AN474K6300D	0.47	90	140	1921	903	30	5.7	20
STHVF-AN684K6300D	0.68	90	140	1921	1306	30	5.4	25
STHVF-AN105K6300D	1	90	250	1921	1921	50	5.1	25
STHVF-AN125K6300D	1.2	90	250	1921	2305	50	4.8	25
STHVF-AN155K6300D	1.5	90	250	1921	2882	50	4.5	30

**STHVF-AN : 8000Vdc / 2500Vac**

P/N :	Cn uF	Diameter D mm	Length L mm	dv/dt v/us	Peak Current I <sub>p-p</sub> A	ESL nH	ESR (mohm) 100KHz	Max. I <sub>rms</sub> 70C
STHVF-AN334K8kD	0.33	65	140	2838	937	30	5.1	18
STHVF-AN474K8kD	0.47	90	140	2838	1334	30	4.8	20
STHVF-AN684K8kD	0.68	90	140	2838	1930	30	4.6	25
STHVF-AN105K8kD	1	90	250	2838	2838	50	4.2	25
STHVF-AN125K8kD	1.2	90	250	2838	3406	50	4.0	25
STHVF-AN155K8kD	1.5	90	250	2838	4257	50	3.8	30

**STHVF-AN : 10000Vdc / 3000Vac**

P/N :	Cn uF	Diameter D mm	Length L mm	dv/dt v/us	Peak Current I <sub>p-p</sub> A	ESL nH	ESR (mohm) 100KHz	Max. I <sub>rms</sub> 70C
STHVF-AN224K10kD	0.22	65	140	3478	765	30	6.4	15
STHVF-AN334K10kD	0.33	90	140	3478	1148	30	5.3	20
STHVF-AN474K10kD	0.47	90	140	3478	1635	30	4.6	25
STHVF-AN684K10kD	0.68	90	250	3478	2365	50	4.3	25
STHVF-AN105K10kD	1	90	250	3478	3478	50	4.1	30

**STHVF-AN : 12000Vdc / 3400Vac**

P/N :	Cn uF	Diameter D mm	Length L mm	dv/dt v/us	Peak Current I <sub>p-p</sub> A	ESL nH	ESR (mohm) 100KHz	Max. I <sub>rms</sub> 70C
STHVF-AN154K12kD	0.15	65	250	3900	585	50	6.5	15
STHVF-AN224K12kD	0.22	90	250	3900	858	50	6	20
STHVF-AN334K12kD	0.33	90	250	3900	1287	50	5.5	30

**STHVF-AN : 15000Vdc / 3700Vac**

P/N :	Cn uF	Diameter D mm	Length L mm	dv/dt v/us	Peak Current I <sub>p-p</sub> A	ESL nH	ESR (mohm) 100KHz	Max. I <sub>rms</sub> 70C
STHVF-AN124K15kD	0.12	65	250	4363	524	50	12	15
STHVF-AN154K15kD	0.15	90	250	4363	654	50	10	15
STHVF-AN224K15kD	0.22	90	250	4363	960	50	8	20

**STHVF-AN : 20000Vdc / 4200Vac**

P/N :	Cn uF	Diameter D mm	Length L mm	dv/dt v/us	Peak Current I <sub>p-p</sub> A	ESL nH	ESR (mohm) 100KHz	Max. I <sub>rms</sub> 70C
STHVF-AN154K20kD	0.15	65	295	6968	1045	60	8	20
STHVF-AN224K20kD	0.22	90	295	6968	1533	60	7.6	25
STHVF-AN254K20kD	0.25	90	295	6968	1742	60	7.2	30
STHVF-AN334K20kD	0.33	90	295	6968	2299	60	6.8	40
STHVF-AN504K20kD	0.5	90	295	6968	3484	70	6.5	50

For any Capacitance, Voltage, dv/dt and Peak Pulse Discharge Current not listed, please contact us for a suggestion.

**STHVF-AN : 2500Vdc / 4500Vac**

<b>P/N :</b>	<b>Cn uF</b>	<b>Diameter D mm</b>	<b>Length L mm</b>	<b>dv/dt v/us</b>	<b>Peak Current I<sub>p-p</sub> A</b>	<b>ESL nH</b>	<b>ESR (mohm) 100KHz</b>	<b>Max. I<sub>rms</sub> 70C</b>
STHVF-AN104K25kD	0.1	65	295	8710	871	70	10	15
STHVF-AN124K25kD	0.12	65	295	8710	1045	70	9.2	18
STHVF-AN154K25kD	0.15	65	295	8710	1307	70	8.4	20
STHVF-AN224K25kD	0.22	90	295	8710	1916	70	7.6	25
STHVF-AN254K25kD	0.25	90	295	8710	2178	70	6.8	30
STHVF-AN274K25kD	0.27	90	295	8710	2352	70	6.0	30

For any Capacitance, Voltage, dv/dt and Peak Pulse Discharge Current not listed, please contact us for a suggestion.